

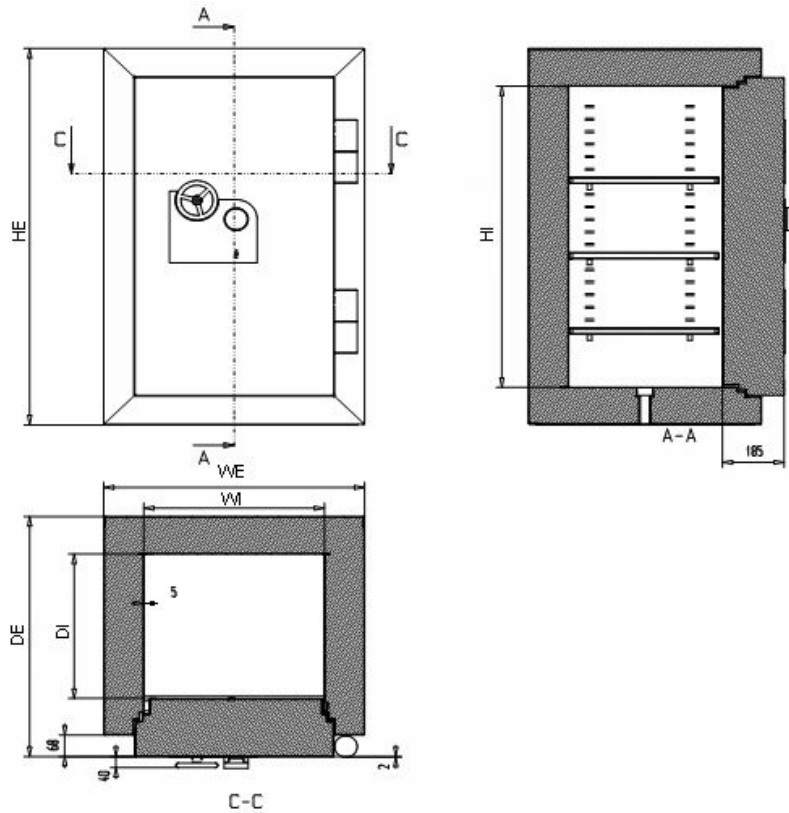

KONSMETAL-POLTREZOR Sp.j.

Al. Jerozolimskie 103, 02-011 Warszawa, Poland
tel./fax. (+4822) 622-59-68, (+4822) 629-80-11

Strongboxes grade VIII



Strongboxes – series of types:

Models	External dimensions			Internal dimensions				Capacity [dm ³]	Weight [kg]	Door opening radius
	H	W	D	H	W	D	Int. Width (in trade)			
KP 120	1200	780	765	960	530	460	525	234	1420	635
KP 150	1500	780	765	1260	530	460	525	307	1700	635
KP 180	1800	780	765	1560	530	460	525	380	1950	635

The overall external dimensions are a result of external product measurement (Int. width) and the handle knob being the most protruding element.

Technical parameters:

- Six movable horizontal bolts
- Six fixed horizontal bolts
- Overall casing thickness # 120 mm,
- Door thickness # 185 mm,
- External casing sheet thickness: 2 mm,
- Internal casing sheet thickness: 1,5 mm,
- Door opening radius 180°,
- Hole at the bottom \varnothing 28 mm for expansion anchor M16 x 200
- Round handle

Models	Handle knob	
	Height	Diameter
KP 120	40	125
KP 150	40	125
KP 180	40	125

Lock used

- coded 4- disc mechanical lock class C, VdS class III
- key lock class C, VdS class III (2 key)

Suggested configurations of locks

- coded (mechanical) and key lock
- two key locks

Additional accessories

1. Key lock & coded lock
2. Shelves – maximum load per shelf – 50 kg

Strongbox	No. of shelves
KP 120	3
KP 150	4
KP 180	4

Possible smooth shelf suspension regulation

1. Shelf hooks – 4 pieces per shelf
2. One extension screw for fitting to the base.
3. Two keys for key lock.
4. Key for code change in the installed coded mechanical lock
5. Lead of alarm system wiring
6. RAL 7035 colour
7. Technological threaded hole with M24 thread for mounting of couplings for transportation

Additional accessories

1. Safe deposit box

Models	Height	Width	Depth	Door opening	
				Height	Width
KP 120	278	530	446	180	405
KP 150	278	530	446	180	405
KP 180	278	530	446	180	405

The chamber is locked individually with a key lock. Standard version is fitted with one safe deposit box (T marking). Additional safe deposit boxes may be installed on personal request, also at the bottom of the main strongbox (in such case the customer assembled the safe deposit box according to the instruction manual).

2. All colours from the RAL palette (RAL 9005 – without extra charge),
3. Bolt-position & door-opening sensors.